

Flanged LDMOST ceramic package; 2 mounting holes; 4 leads

SOT1121A

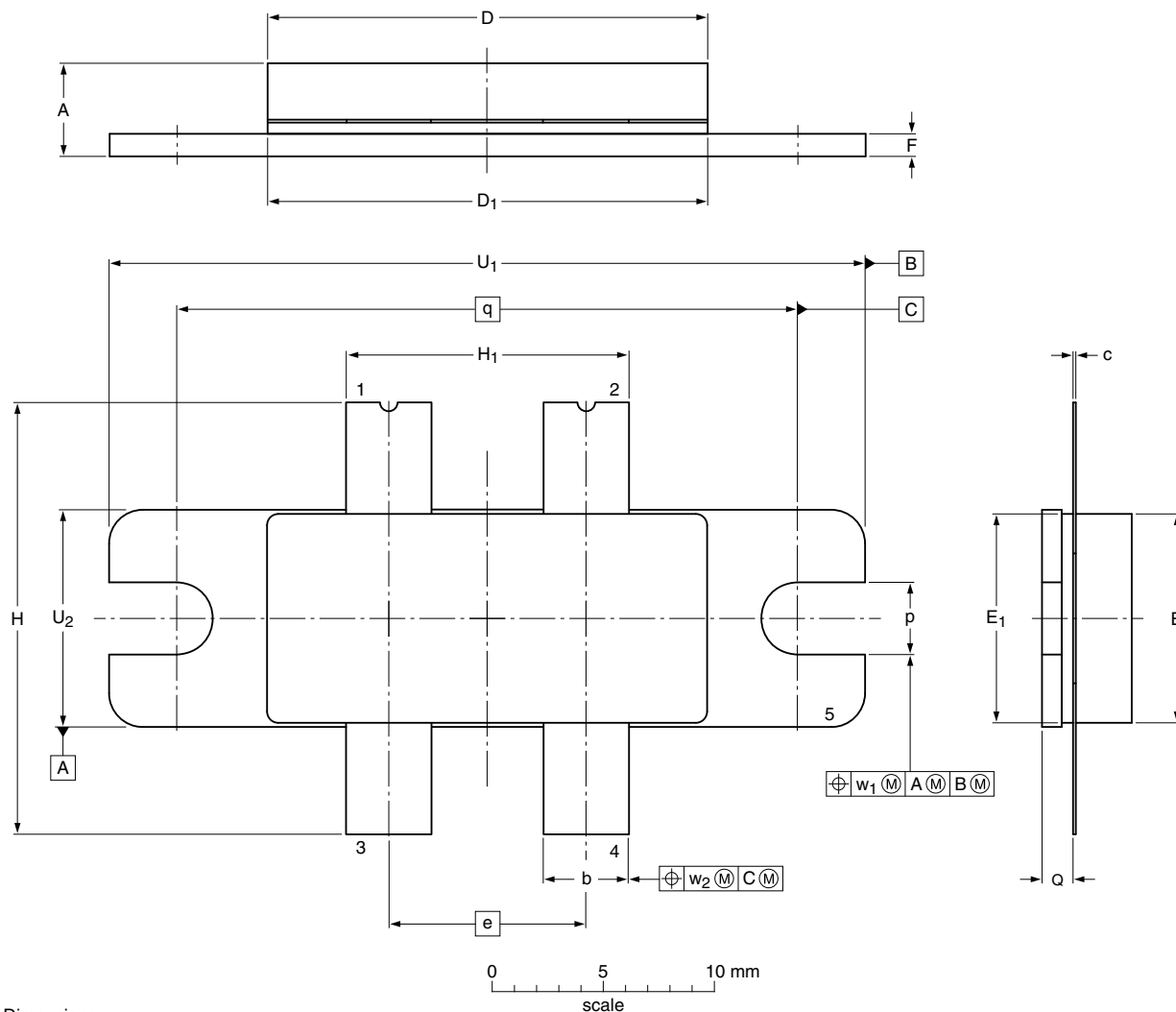

Dimensions

Unit ⁽¹⁾	A	b	c	D	D ₁	e	E	E ₁	F	H	H ₁	p	Q ⁽²⁾	q	U ₁	U ₂	w ₁	w ₂
mm	max 4.75	3.94	0.18	20.02	19.96	8.89	9.53	9.53	1.14	19.94	12.83	3.38	1.70	27.94	34.16	9.91	0.25	0.51
	nom 3.45	3.68	0.10	19.61	19.66		9.27	9.27	0.89	18.92	12.57	3.12	1.45		33.91	9.65		
	min 0.187	0.155	0.007	0.788	0.786		0.375	0.375	0.045	0.785	0.505	0.133	0.067		1.345	0.39		
inches	nom 0.136	0.145	0.004	0.772	0.774	0.35	0.365	0.365	0.035	0.745	0.495	0.123	0.057	1.1	1.335	0.38	0.01	0.02
	min 0.136	0.145	0.004	0.772	0.774		0.365	0.365	0.035	0.745	0.495	0.123	0.057		1.335	0.38		

Note

1. millimeter dimensions are derived from the original inch dimensions.
2. dimension is measured 0.030 inch (0.76 mm) from the body.

sot1121a_po

Outline version	References				European projection	Issue date
	IEC	JEDEC	JEITA			
SOT1121A						09-10-12 10-02-02