

Earless flanged balanced ceramic package; 4 leads

SOT539B

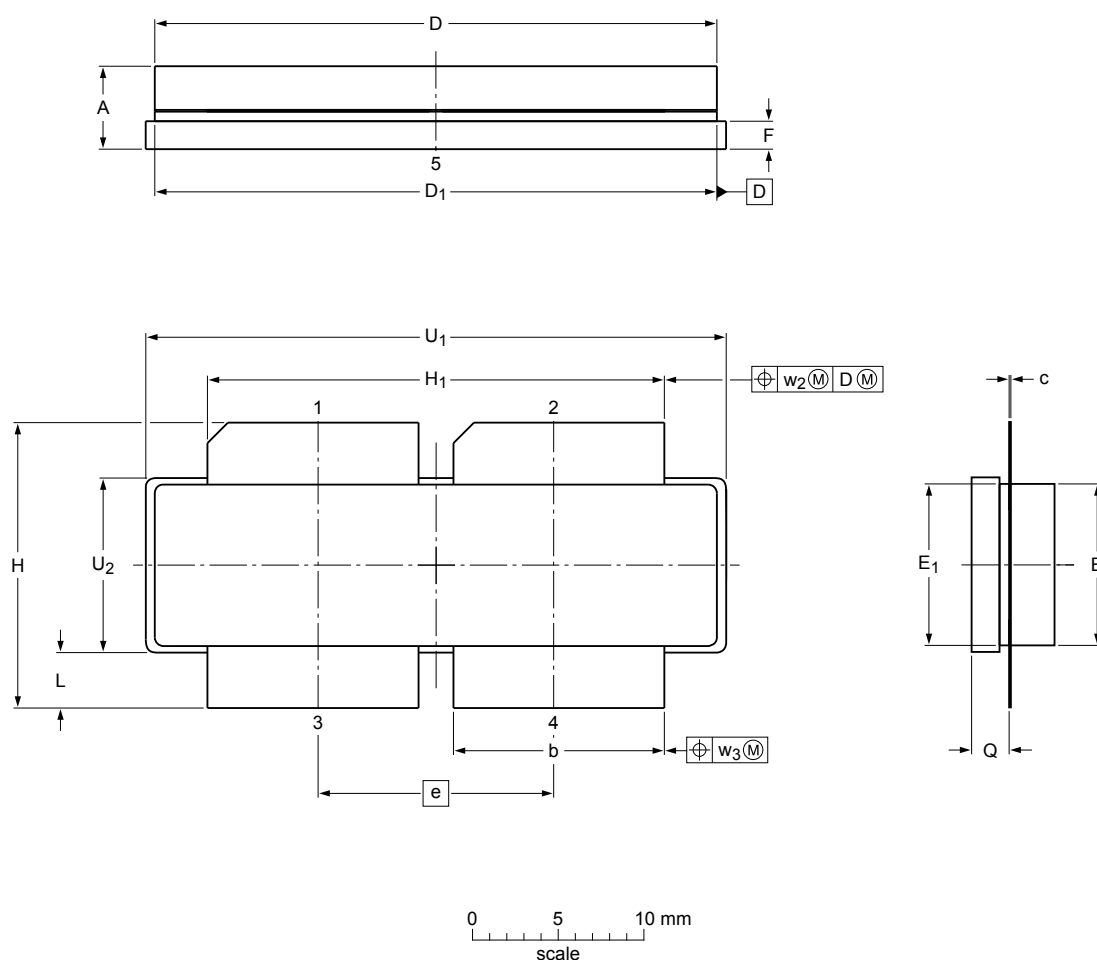

Dimensions

Unit ⁽¹⁾		A	b	c	D	D ₁	E	E ₁	e	F	H	H ₁	L	Q	U ₁	U ₂	w ₂	w ₃
mm	max	4.7	11.81	0.18	31.55	31.52	9.5	9.53	13.72	1.75	17.12	25.53	3.48	2.26	32.39	10.29	0.25	0.25
	nom min	4.2	11.56	0.10	30.94	30.96	9.3	9.27		1.50	16.10	25.27	2.97	2.01	32.13	10.03		
inches	max	0.185	0.465	0.007	1.242	1.241	0.374	0.375	0.54	0.069	0.674	1.005	0.137	0.089	1.275	0.405	0.01	0.01
	nom min	0.165	0.455	0.004	1.218	1.219	0.366	0.365		0.059	0.634	0.995	0.117	0.079	1.265	0.395		

Note

1. millimeter dimensions are derived from the original inch dimensions.

sot539b_po

Outline version	References				European projection	Issue date
	IEC	JEDEC	JEITA			
SOT539B						12-05-02 13-05-24